

NOTES

1. ALL INSITU MAKE-UP BY THE GENERAL CONTRACTOR.
2. BRICK/INSITU INFILL AT STAGGERED BEARINGS BY THE GENERAL CONTRACTOR.
3. DOUBLE OR TRIPLE BEAMS TO BE INFILLED WITH C30 CONCRETE BY THE GENERAL CONTRACTOR.
4. WHERE NECESSARY A D.P.C. SHOULD BE LAID PRIOR TO THE INSTALLATION OF THE P.C. UNITS.
5. VOIDS UNDER FLOORS SHOULD BE VENTILATED IN COMPLIANCE WITH CURRENT BUILDING REGULATIONS.
6. WALL ANCHOR STRAPS MAY BE FIXED TO THE P.C. FLOOR BY THE G.C. AFTER INSTALLATION AND SHOULD BE SET OUT IN COMPLIANCE WITH CURRENT BUILDING REGS. OR AS SPECIFIED BY THE STRUCTURAL ENGINEER.
7. ANY ADDITIONAL HOLES REQUIRED THROUGH THE FLOOR SHOULD BE FORMED BY DRILLING OR REMOVING AN INFILL BLOCK.
8. THIS DRAWING IS TO BE READ IN CONJUNCTION WITH ALL RELEVANT ARCHITECT AND ENGINEERS DRAWINGS.
9. 150mm P.C. UNITS SUPPLIED IN 50mm INCREMENTS & 215mm P.C. UNITS SUPPLIED IN 25mm INCREMENTS ONLY.
10. SPLIT COURSE BLOCKS CAN ONLY BE SUPPLIED IN 100mm WIDTHS. ONLY TO BE USED ON 140mm WALLS AT GENERAL CONTRACTORS OR STRUCTURAL ENGINEERS DISCRETION.
11. CONSTRUCTION LOADS MUST NOT EXCEED DESIGN LOADINGS BELOW. ONLY LAND BLOCKS AT THE BEARING ENDS OF THE P.C. UNITS AND DO NOT DOUBLE STACK.

	Dwelling	Garage
LOADINGS		
SUPER FINISHES	1.50 kN/m ²	2.50 kN/m ²
FINISHES	1.80 kN/m ²	1.80 kN/m ²
PARTITIONS		
STUD BLOCK	4.00 kN/m	

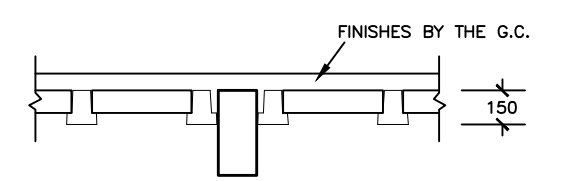
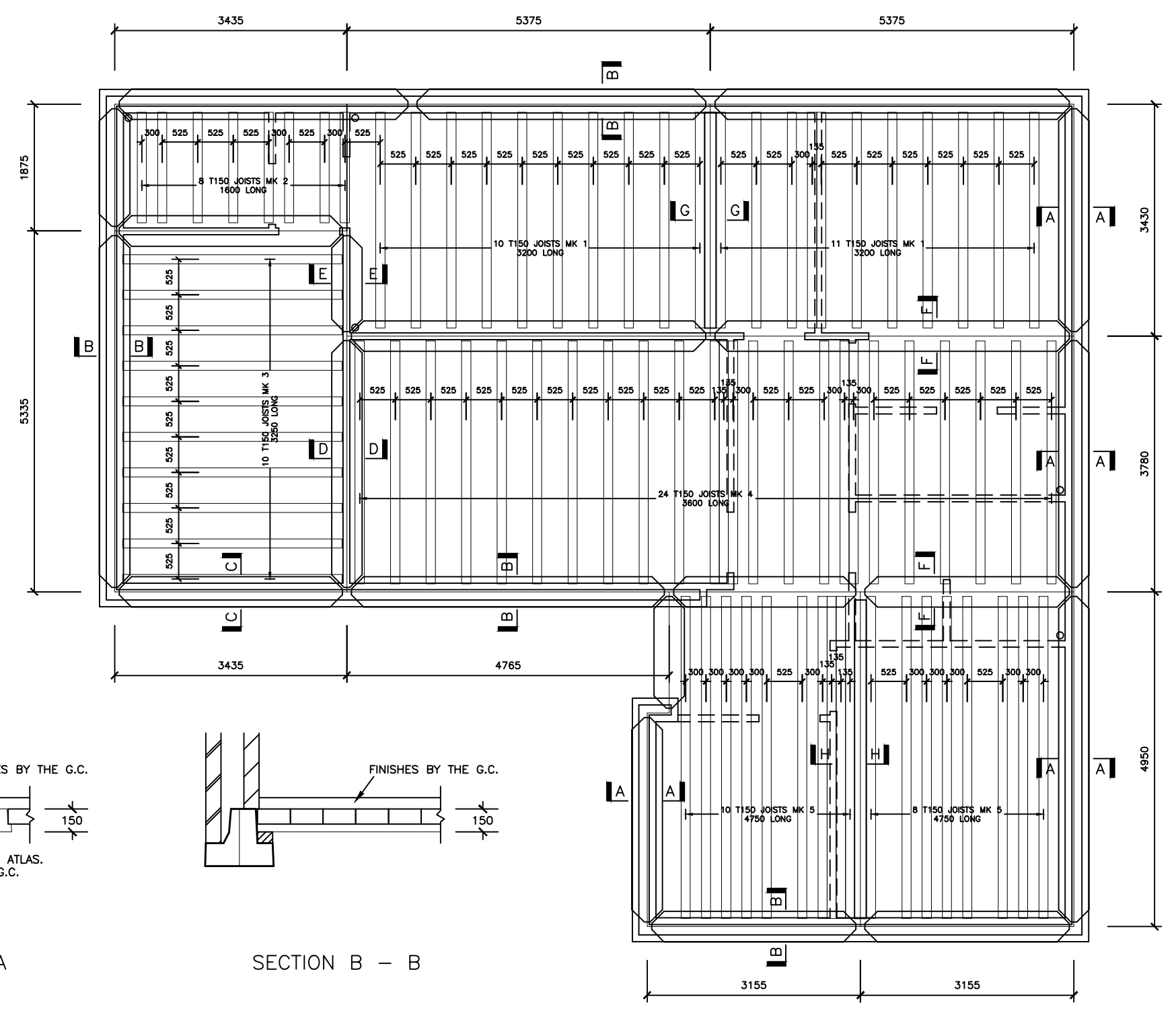

SECTION G - G

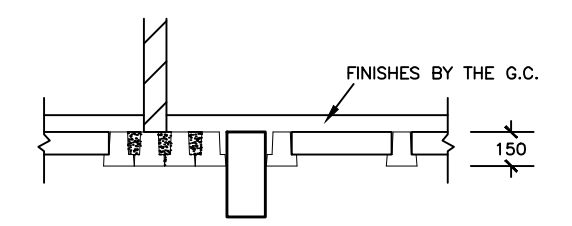

SECTION H - H

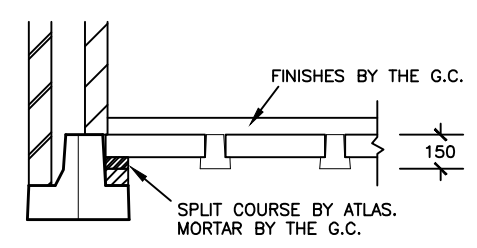

SECTION A - A

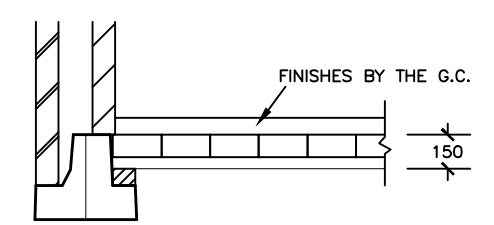

SECTION B - B

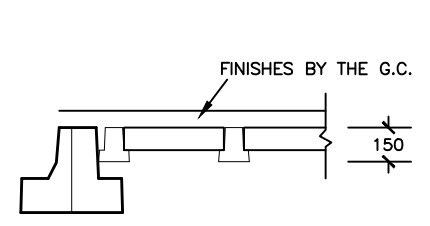

SECTION C - C

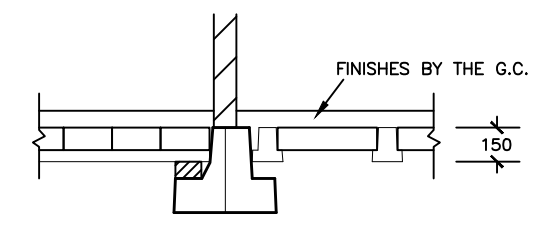

SECTION D - D

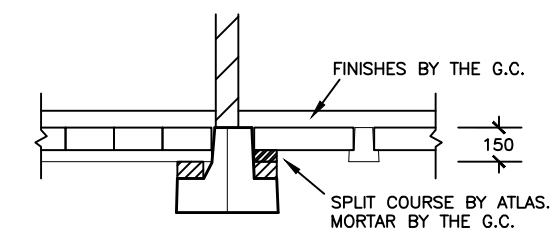

SECTION E - E

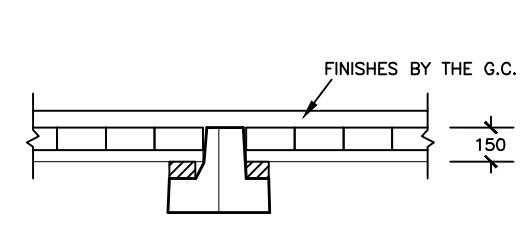

SECTION F - F

Rev	Description	Date
Job Title		
EDENSIDE CARLISLE		
PLAN SHOWING LAYOUT OF 150mm DEEP P.C. UNITS AT GROUND FLOOR LEVEL PLOT 5		
Scale	1:75 @ A3	Drawn by: Mark Cawley
Date	11/04/17	Contract No.
Drg No.	AT 13346 / 03	Rev. -

ATLAS
CONCRETE LIMITED

PRE-STRESSED CONCRETE SPECIALISTS
Hangar 44, Silloth, Cumbria, CA7 4PA
Tel: 016973 32585 Fax: 016973 32546