

**ELEVATION 1-1**  
SCALE 1:50  
(FROM OUTSIDE)

**ELEVATION 2-2**  
SCALE 1:30

**ELEVATION 3-3**  
SCALE 1:30  
(FROM OUTSIDE)

LIFT PIT IS TO BE DOWELED AND GROUTED IN BEFORE OTHER UNITS ARE ERECTED.

LIFT PIT IS TO BE BEVELED WITH STEEL SHIMS, VOID BETWEEN UNDERSIDE OF SLAB AND FOUNDATION TO BE FILLED AND COMPACTED WITH NON-SHRINK GROUT BY BUILDER.

LIFT PIT SUPPLIED WITH 2No. COATS OF RW LAC TO OUTER SURFACE OF WALLS AND TO THE UNDERSIDE OF THE SLAB. ADDITIONAL TANKING, AS REQUIRED, BY BUILDER.

FOUNDATION TO BE DESIGNED BY OTHERS TO CATER FOR DEAD WEIGHT OF LIFT SHAFT AND OVERTURNING MOMENT. SEE LIFT MANUFACTURERS INFORMATION FOR APPLIED LOADINGS FROM LIFT.

LIFT SHAFT SECTIONS TO BE BEDDED ON SHIMS & SF BEDDING MORTAR (BY PAREX). 50 DIA HOLES TO BE GROUTED WITH CS GROUT (BY PAREX IN ACCORDANCE WITH THEIR TECHNICAL DATA).

THIS DRAWING TO BE READ IN CONJUNCTION WITH LIFT MANUFACTURERS DRAWINGS.

⊕ INDICATES A LIFTING POINT  
⊕ INDICATES TIE DETAILS AT CORNERS.

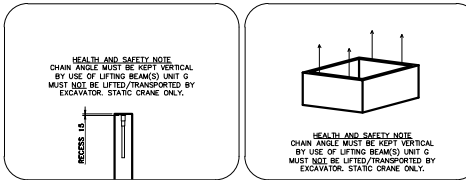
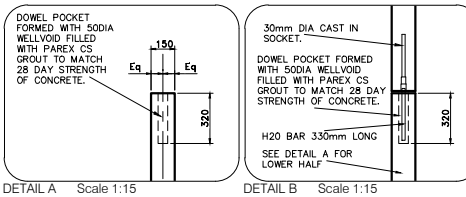

**LEVEL OF TOP OF UNITS TO BE CHECKED AFTER EACH UNIT HAS BEEN INSTALLED & PACKS ARE TO BE ADJUSTED TO ACHIEVE THESE LEVELS.**

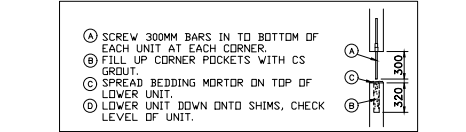

**MANUFACTURING TOLERANCE +/- 10mm UNITS TO BE INSTALLED PLUMB TO LIFT MANUFACTURERS TOLERANCE AND IS TO BE CHECKED AND ADJUSTED AT EACH LEVEL. INTERNAL FACE OF SHAFT TO BE PAINTED WITH 2 COATS OF WHITE PAINT.**

**REINFORCEMENT:**  
WALLS - A252 MESH 2No. LAYERS  
UNIT 25 - A393 MESH 2No. LAYERS

- NOTES:**
- DO NOT SCALE FROM THIS DRAWING.
  - ALL DIMENSIONS ARE IN MILLIMETRES UNLESS OTHERWISE ALL DIMENSIONS ARE SPECIFIED IN METRES.
  - THIS DRAWING TO BE READ IN CONJUNCTION WITH ALL OTHER RELEVANT DRAWINGS AND SPECIFICATIONS.
  - ALL PREPARATION WORK TO BE IN ACCORDANCE WITH MANUFACTURERS INSTRUCTIONS AND RECOMMENDATIONS.
  - REINFORCED CONCRETE: WEAR AND REPAIR CONCRETE CONCRETES (GRADE C40/50 (P16))
  - CONCRETE FINISHES: TYPE A: FORMED FINISHES
  - CAST TO RECOMMENDED TO BE 30mm
  - MINIMUM HEIGHT OF REINFORCING UNITS BASED ON 150mm
  - MIN RESISTANCE: 150kN
  - CAST TO RECOMMENDED TO BE 30mm
  - REINFORCED CONCRETE: WEAR AND REPAIR CONCRETE CONCRETES (GRADE C40/50 (P16))
  - CONCRETE FINISHES: TYPE A: FORMED FINISHES
  - CAST TO RECOMMENDED TO BE 30mm
  - MINIMUM HEIGHT OF REINFORCING UNITS BASED ON 150mm
  - MIN RESISTANCE: 150kN
  - CAST TO RECOMMENDED TO BE 30mm
  - REINFORCED CONCRETE: WEAR AND REPAIR CONCRETE CONCRETES (GRADE C40/50 (P16))
  - CONCRETE FINISHES: TYPE A: FORMED FINISHES
  - CAST TO RECOMMENDED TO BE 30mm
  - MINIMUM HEIGHT OF REINFORCING UNITS BASED ON 150mm
  - MIN RESISTANCE: 150kN

SEE DRAWING 33625 FOR PLANS

Revision	Description	Date
A	ISSUED FOR APPROVAL	11/06/17

**SCHEDULE SUMMARY**

REF	NUMBER OFF	APPROX QT (CUB)
UNIT 31	1 No. Required as Drawn	7.097
UNIT 32	2 No. Required as Drawn	5.927
UNIT 33	1 No. Required as Drawn	5.167
UNIT 34	1 No. Required as Drawn	6.437
UNIT 35	1 No. Required as Drawn	2.597

Job Title

WHITEHAVEN CAMPUS

LIFT SHAFT GENERAL ARRANGEMENT

Scale 1:30 @ A1 Drawn by: CH

Date 11/06/17 Contract No. 3362

Drg No. WEC-ATL-C-ZZ-DR-Y-33624 Rev. P1



LIFT THREE  
1 No. REQUIRED  
AS DRAWN